

Type : **EE55V77-1SM1**

- ✦ High Efficiency and Low Loss
- ✦ Acc. To DIN EN 62368-1
- ✦ UL94-V0 Recognized Materials
- ✦ Class 130°C Insulation System
- ✦ Operating Temperature -40°C to +100°C
- ✦ RoHS Compliant Product
- ✦ Custom Design Available



Electrical Specifications	Core Parameters	Bobbin Parameters
Max. Output Power (at 66kHz) Flyback : - - Half-Bridge : 600 W Operating Frequency : 20 - 140 kHz Isolation (pri-sec) : 3.000 Vrms, 1mA / 5 sec.	Core Type : EE55 Effective Length (le) : 124,0 mm Effective Area (Ae) : 353,0 mm ² Effective Volume (Ve) : 43900 mm ³	Core Direction : Vertical Number of Pins : 7+7 Max. Winding Width : 33,7 mm Max. Winding Height : 9,7 mm Winding Area : 325,2 mm ²

Dimensions [mm]

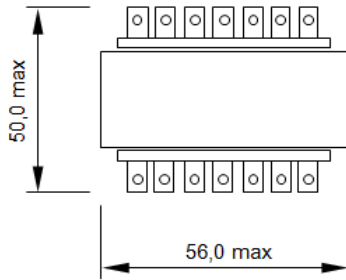
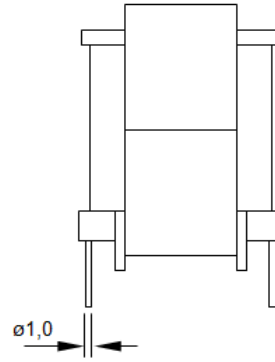
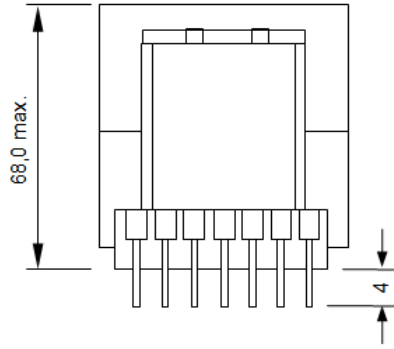

Pin configuration
(Bottom view)

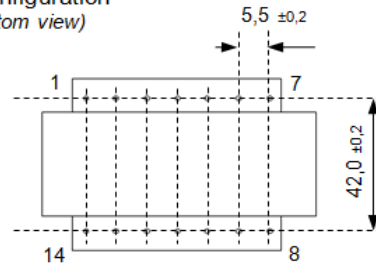

Recommended hole : $\phi 1,2$ (NPTH)
 $\phi 1,4$ (PTH)

The parameters of the product are given as an example. Data are subject to change without prior notice.

Revised : 20-Jan-2022